

True *Interoperability* for the CAD Industry

The Elysium family of data exchange products provides complete solutions from the desktop to corporate services.

The CADporter products plug-in to your standard CAD environment and provide easy to use translation capabilities.

The Elysium data exchange foundation understands the characteristics of each of the supported CAD systems and can make the required adjustments and corrections required for any data conversion.

CADporter provides bidirectional, geometry-based translation, with automatic healing that solves these common problems:

- **Transparent conversion** of surface definitions
- Seamless healing** of models from different tolerances
- Intelligent healing** of trim curves with surfaces
- Correct resolution** of topology differences between systems

CADporter can minimize your translation issues by using the experience and intelligence built into the Elysium data exchange kernel to convert your data correctly the first time. This allows you to focus on the product development task rather than data exchange problem solving.

Key Features

- ✦ Ease of data sharing between heterogeneous CAD/CAM and PLM systems
- ✦ Reliable solid to solid conversion (B-rep)
- ✦ Little or no time spent in data clean-up
- ✦ Complete translation of product structure
- ✦ Simple User Interface for import and export

Supported Systems

AutoDesk Inventor

Dassault Systems / IBM

□ • CATIA V4 & V5

□ • SolidWorks

EDS PLM Solutions

□ • I-deas

□ • Unigraphics

PTC Pro/Engineer

IGES, Parasolid, STL

Platform Support

IBM/AIX

HP-RISC/HP-UX

SGI/IRIX

Sun/Solaris

Windows NT/2000/XP

CAD • porter

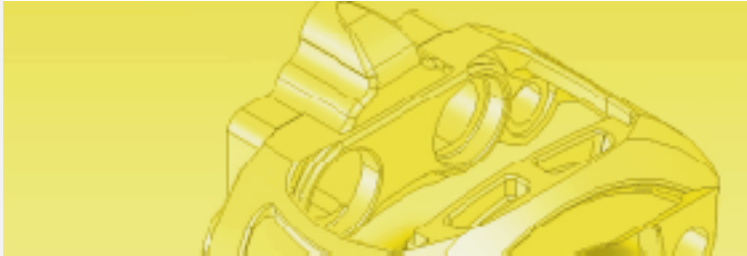

Benefits of Direct Translation

Many companies use IGES or other standards based translation to communicate between different CAD systems. The costs associated with these lowest common denominator translations has been documented at over \$1B per year (NIST 1999). Elysium's focused direct translators can reduce this cost significantly by eliminating the hit or miss interpretation required with standards based translators.

Standards based translations depend on two independent development organizations interpreting the standard and then creating software to read and write files. If any issues arise, the user must determine the source of the problem and then wait and see if there is any incentive for the developer to correct the issue. With direct translation from Elysium, the middle-man is eliminated and the customer deals with only Elysium – A company dedicated to data exchange.

CADporter provides the reliable and seamless conversion of data that is required for today's complex business processes.



CONTACT

Elysium Inc.

200 Galleria Officentre, Suite 109
Southfield, MI 48037 USA
Tel. +1-248-799-9800
Fax. +1-248-281-0672
Web: www.elysiuminc.com
Email: info@elysiuminc.com

About Elysium Inc.

Founded in 1984, Elysium bridges the gap between CAD systems and enables PDM and product structure synchronization with its industry-leading technologies. Elysium's CADporter™, CADdoctor™, CADfeature™, CADpdm™ and CADserver™ software products enable the translation of all geometry from one CAD system to another with the industry's highest success rate.

Platforms supported include ACIS, CATIA, I-deas, Inventor, Parasolid, Pro/ENGINEER and SolidWorks. Elysium has successful partnerships with all major CAD / CAM / CAE and MCAD software companies including Abaqus, Autodesk, CoCreate, Dassault, EDS PLM, Maya Metrix, PTC, and Spatial Corporation. Elysium is a member of the AIAG and is a sponsor of the Renault F-1 race team.

For additional information about Elysium's products and services, please visit www.elysiuminc.com.

CADporter, CADserver, CADdoctor, CADfeature and CADpdm are trademarks of Elysium Co., Ltd. and Elysium Inc. All other products are trademarks or registered trademarks of their respective companies.

